

Hyne Beam 15C is a high-strength, aesthetic, glue-laminated timber beam

[View miproducts listing](#)



## Level of assurance needed to demonstrate NZ Building Code Compliance

Supporting documentation should include self-assessment and technical information by manufacturer



Hyne I-Built™ confirms that this minimum level of assurance has been met or exceeded by the following:

Product Assurance Supplier Statement

[PASS - 19263](#)



The following information has been provided by Hyne I-Built™ demonstrating how this product complies with the [Building Product Information Requirements](#).

## Technical Statement

### Product Class

CLASS 1

### Product Description

For use in interior applications with high loads or those that require long spans, including beams, columns, floor joists, roof rafters, girts, purlins and similar structural applications.

Popular with architects, Hyne Beam 15C has been used as beautiful lintels, bearers, roof beams, rafters, curves, columns and portal frames in a number of amazing structures.

### Stocked Sizes:

- 85mm width x 195, 230, 260, 295, 330, 360, 395, 425, 460mm
- 130mm width x 230, 260, 295mm

### Other cross section sizes are available by order:

- 85mm width x 130, 165, 590mm
- 130mm width x 195, 330, 360, 395, 425, 460, 495, 525mm

Custom sizes can be designed to suit special applications up to 1200mm in depth.

**GRADES:** I-Built Hyne Beam 15C is available in two grades in accordance with AS/NZS1328.1-1998.

- STR – Structural Grade or Appearance B.
- SEL – Select Grade or Appearance A.

### Scope of use

Location - In wind zones up to and including extra high as defined in NZS 3604:2011 or to a maximum wind design pressure (ULS) of ULS 2.1 kPa. In all exposure zones as defined in NZS 3604:2011. In all Seismic and snow zones. At least 1m from a relevant or notational boundary.

In conjunction with a primary structure that complies with the NZ Building Code or where the designer has established that the existing structure is suitable for the intended building work. In conjunction with timber framing as defined in NZS 3604:2011 or designed in accordance with AS/NZS 1170 (set). As a direct substitute to SG8, SG10, and SG12 (or other equivalent engineered timber products) as referenced in section 8 NZS 3604:2011 or where specifically engineered to NZS 3603:1993 or AS/NZS 1170 (set).

### New Zealand Building Code (NZBC)

The product will, if employed in accordance with the supplier's installation and maintenance requirements, assist with meeting the following provisions of the building code:

- **Clause B1 Structure:** Performance B1.3.1, B1.3.2, B1.3.3, B1.3.3(a), B1.3.3(b), B1.3.3(f), B1.3.3(j), B1.3.3(m), B1.3.3(q), B1.3.4, B1.3.4(a), B1.3.4(b), B1.3.4(c), B1.3.4(d), B1.3.4(e)

Manufactured in accordance with AS/NZS 1328.1:1998, as referenced in clause 2.3.9, NZS 3604:2011. Holds Bureau Veritas S-Mark Licence No. 2757 [Bureau Veritas, 14/09/2023].

Characteristic properties to AS/NZS 4063 [Griffith University, 11/21]

- **Clause B2 Durability:** Performance B2.3.1, B2.3.1(a), B2.3.2, B2.3.2(a)

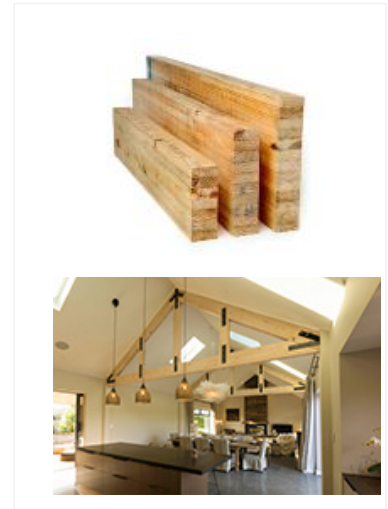

## masterspec partner

### Company Contact Details



Company: New Zealand Wood Products Limited

Physical Address: 149 Kerrs Road  
Wiri  
AUCKLAND

Postal Address: PO Box 76412  
Manukau  
AUCKLAND

Telephone: 64 09 2686540

Email: [enquiries@nzwoodproducts.co.nz](mailto:enquiries@nzwoodproducts.co.nz)

Website: <http://nzwoodproducts.co.nz/>

In accordance with para.1.9, AS/NZS 1604.5:2012, the penetration and retention characteristics meet the specifications outlined in NZS 3640:2003. > Glue-line integrity meets service class 3 in accordance with AS/NZS 1328.1:1998 [Hyne Timber 10/21a,b].

Timber Preservation ABN: 15 109 657 276. Timber treated to Hazard Class H3 (H3.1 for New Zealand) [Cahill Timber, 25/09/2023].

Exposure conditions specified by AS/NZS 1604.1:2021.

- **Clause F2 Hazardous building materials:** Performance F2.3.1

Use in accordance with the manufacturer's safety information.

Formaldehyde emission rate of less than 0.3 mg/L verified through panel testing to AS/NZS 4357.4. Meets Super E0 Emission Class requirements in accordance with AS/NZS 2269.0 [Hyne Timber 10/21a, b]

## Evidence

The product meets the requirements set out in the following documents, or relevant parts of cited standards within the documents:

The product will, if installed in accordance with the supplier's installation and maintenance requirements, assist with meeting the following provisions of the building code:

## Supporting Evidence

The product has and can make available the following additional evidence to support the above statements:



Product Assurance Supplier Statement

[PASS - 19263](#)

## Use in Service History

Specified and supplied to the New Zealand building industry for 20 years.

## Product Criteria

### Design requirements

- In wind zones up to and including extra high as defined in NZS 3604:2011 or to a maximum wind design pressure (ULS) of ULS 2.1 kPa.
- In all exposure zones as defined in NZS 3604:2011.
- In all seismic zones.
- In all snow zones.
- At least 1 m from a relevant or notional boundary

### Installation requirements

- In conjunction with a primary structure that complies with the NZ Building Code or where the designer has established that the existing structure is suitable for the intended building work.
- In conjunction with timber framing as defined in NZS 3604:2011 or designed in accordance with AS/NZS 1170 (set).
- As a direct substitute to SG8, SG10, and SG12 (or other equivalent engineered timber products) as referenced in section 8 NZS 3604:2011 or where specifically engineered to NZS 3603:1993 or AS/NZS 1170 (set).

### Maintenance requirements

- The treatment level must be appropriate to the hazard class applicable to the use of the beam.
- Hyne Beam 15 must only be used for internal applications.
- Fabricated connections must be in accordance with AS/NZS 1170.2:2000.
- Hyne Beam 15 and Hyne Beam 21 must not be ripped if this would reduce the number of lamina.
- Where fire-related NZ Building Code obligations apply, the specification of the beams is subject to specific fire engineering.

## Building Product Information Requirements

### Manufacturer

**Legal Trading Name:**

Hyne & Son Pty Ltd

**Company Website:**

<https://www.hyne.com.au/>

**Contact Number/s:**

+64 09-2686540

0800022352

## Importer

**Legal Trading Name:**

New Zealand Wood Products Limited

**Business Email:**

enquiries@nzwoodproducts.co.nz

**Company Website:**

<http://nzwoodproducts.co.nz/>

**Contact Number/s:**

+64 09-2686540

0800 022352

## Product Identifier

15C19, 15C23, 15C26, 15C29, 15C33, 15C36, 15C39, 15C42

## Warnings

This product has no warnings associated with it.



Date last validated: **29 August 2024**



Date last updated: **29 August 2024**

Disclaimer: The Product Technical Statement (PTS) template is copyright to Construction Information Limited. However the content of this PTS is the responsibility of the product manufacturer/supplier. Refer to the miproducts Terms and Conditions